

High torque and high responsiveness to meet a wide range of needs



● **Small and high torque performance**

By fastening a spring, it generates several times of the torque in a small electromagnetic clutch.

● **Outstanding reactivity**

Distinguished reactivity is come from the isolated structure.

● **Spring tightening torque transfer system adopted.**

Since torque is transmitted by tightening the spring, it has low friction and long life.

● **Ideal for anti-reverse**

It has a one-way clutch function so it can be used for anti-reverse

■ **Dimensions**

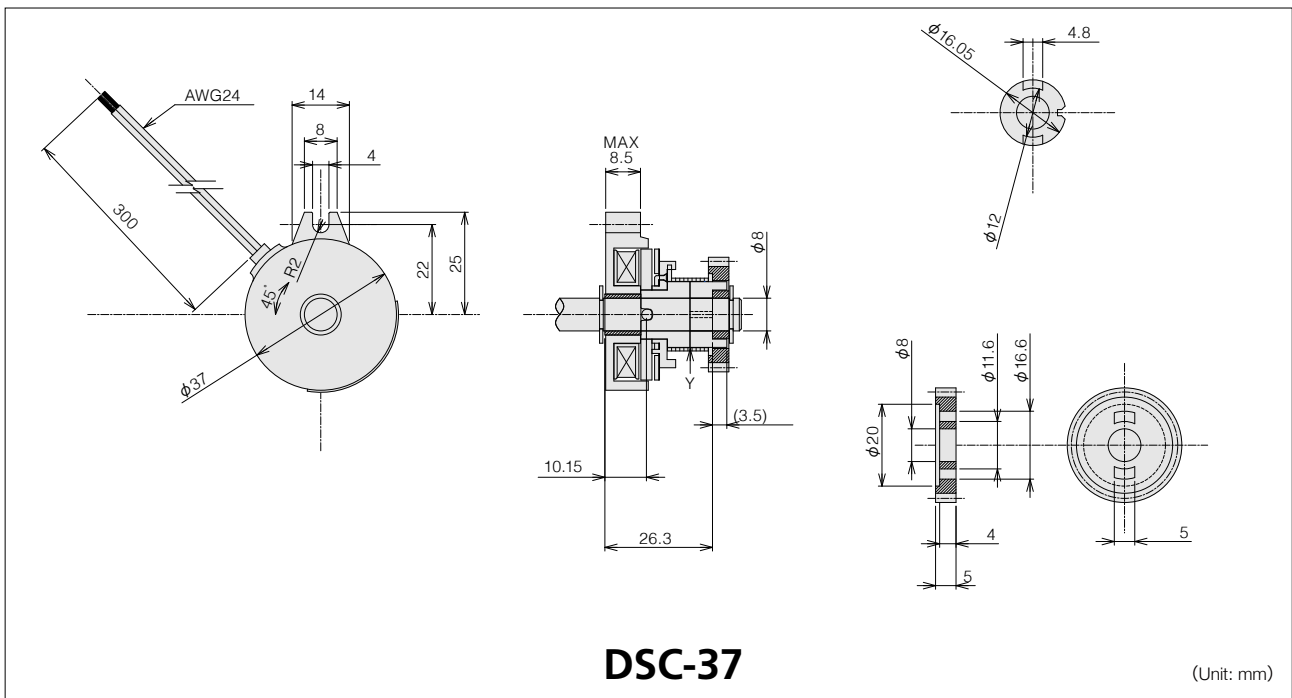

■ **Specifications**

Type	DSC-37
Rated Voltage	DC24V
Capacity	4.8W (±10%)
Static Friction Torque	Above 1.47Nm(15kgfcm)
Insulation Classification	E Class[Electrical Safety·TUV(IEC950)] A Class[UL·CSA]
Withstand Voltage	AC 600V for 1 second
Insulating Resistance	Above 100MQby DC500V-Mega
Safety Standard	The standards of Electrical Safety, UL·CSA·IEC·EN·CE are satisfied
Lead Wire	Standard wire of UL1007·VW-1:CSA·TR-64 AWG24:Black
Shaft	φ2.5 x 12 pin Fixed

Application OA equipment (multifunction machine, printer, printing machine), automatic sales machine, ATM, automobile door for home use, automatic ticket issuing machine, medical equipment, automatic cartoon etc.